



Industrial Filters · Accumulators

# Inline Filters

100 FLE 0020(C) - 0120(C)  
100 FLEN 0160 - 0630

*Filters for inline installation*

*Designed for offline filtration*

*Installation of environment - friendly  
ECOPore Filter Elements with  
reusable core ( central tube )*

*Large filter area*

*Optimised flow characteristics  
by 3D - computer aided design*

*Low pressure drop*

*Special high efficient  
filter media*

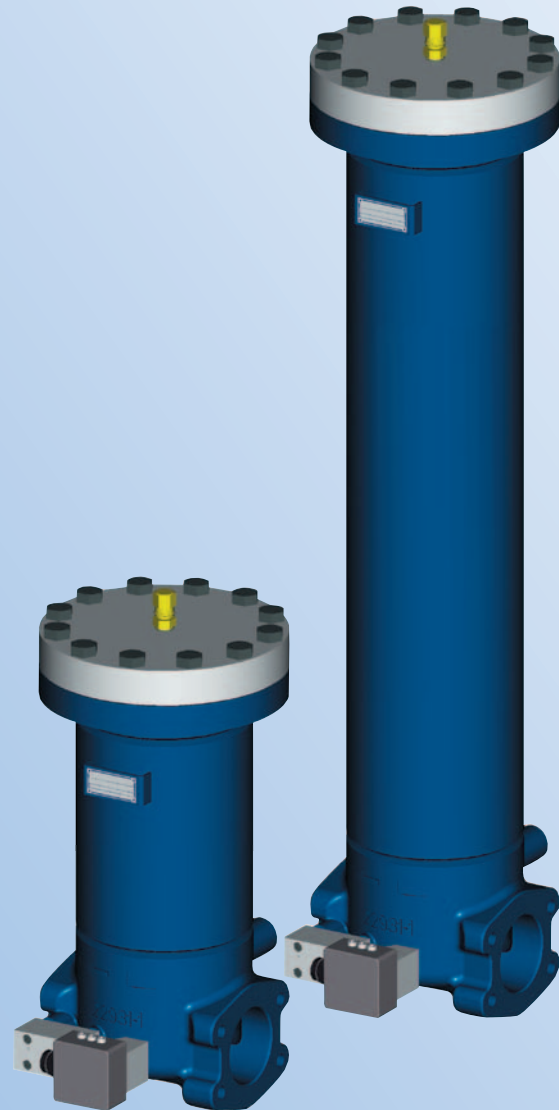

*Operating pressure: 100 bar*

*Connection up to SAE 3"*



Quality assured!

## Inline Filters

100 FLE 0020(C) - 0120(C)  
 100 FLEN 0160 - 0630  
 Operating pressure 100 bar  
 Operating temperature -10°C to +100°C  
 Connection up to SAE 3"

### Application

Filtration of pressurised liquids and lubricants.  
 Filtration of liquids and gases.  
 Direct installation in pipelines. Direct wear protection of subsequent components and systems.  
 Offline filtration with high service time.

### Design

Two part design out of filter housing with inlet and outlet and flange mounted filter cover.

### Filter Element

Pleated design with optimised pleat density and various filter media. The filter element is the most important component of the filter in view of prolonged life and wear protection of the system.

Oil cleanliness, the initial pressure drop and the dirt holding capacity are the most important criteria for selection. For further detailed information please refer our "Filter Elements" brochure. A proper filter selection is enabled by our "EPE - FILTERSELECT" software.

### Accessories

#### Maintenance Indicators

For monitoring the filter element's contamination status, visual and visual/electrical indicators, with one or two switching points are available.

#### Bypass Valve

To protect the filter element during start up and over pressurisation due to clogging.

#### Vent Valve

For removing the air from the filter during starting and for safe de-pressurisation.

K. & H. Eppensteiner GmbH & Co.KG  
 Hardtwaldstraße 43 · D-68775 Ketsch  
 P.O.Box 1120 · D-68768 Ketsch  
 Phone: +49 62 02 / 6 03-0  
 Telefax: +49 62 02 / 6 03-1 99  
 E-Mail: info@eppensteiner.de  
 Internet: www.eppensteiner.de

## Ordering Information

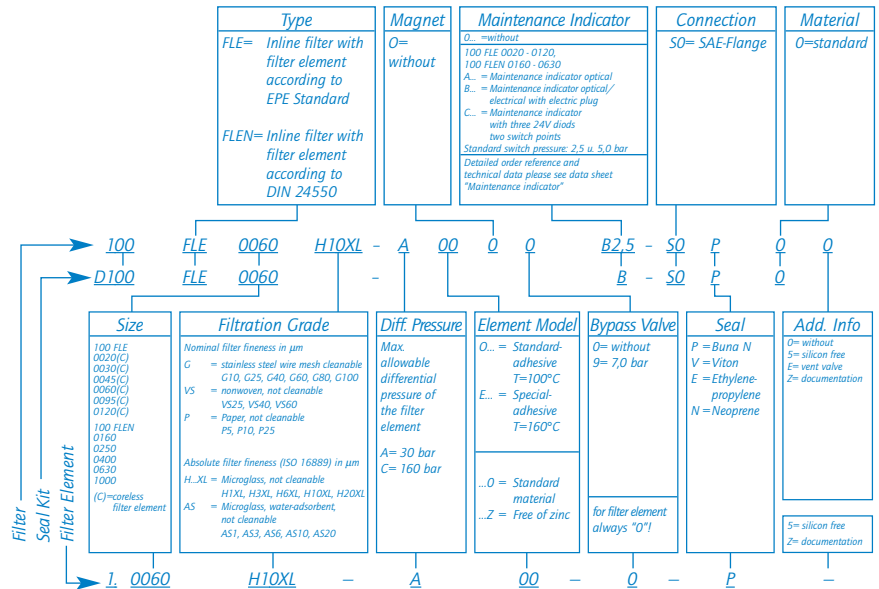

## Dimensions

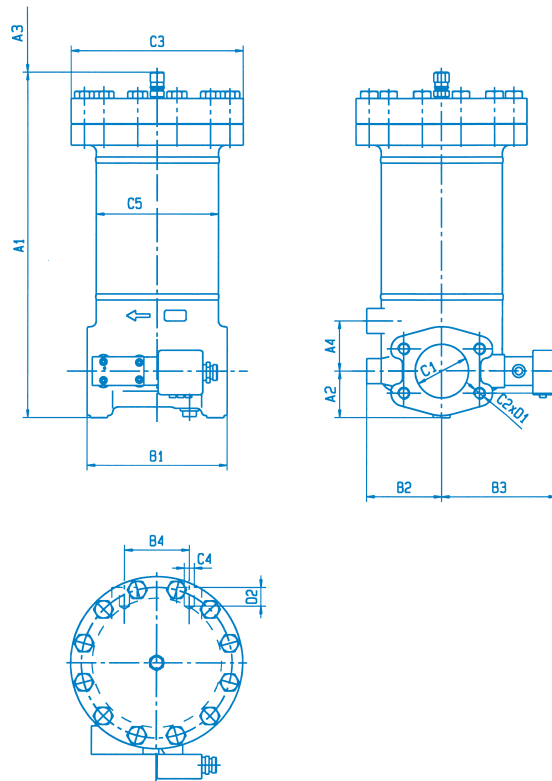

Type	Capacity in l	Weight in kg	A1	A2	A3 <sup>2)</sup>	A4	B1	B2	B3	B4	C1	C2	C3	C4	C5	D1	D2
100 FLE 0020(C)	2,1	22,4	351		160						SAE2"3000psi DN50	M12	Ø200	M16	Ø140	21	22
100 FLE 0030(C)	3,2	28,0	441	50	250	60	160	95	144	70							
100 FLE 0045(C)	5,1	29,0	591		400												
100 FLE 0060(C)		34,0	482		250						SAE3"3000psi DN80	M16	Ø240	M16	Ø170	22	20
100 FLE 0095(C)	7,8	38,3	632	65	400	70	195	105	158	90							
100 FLE 0120(C)	14,3	49,2	989		750												
100 FLEN 0160	2,1	28,0	351		160						SAE2"3000psi DN50	M12	Ø200	M16	Ø140	21	22
100 FLEN 0250	3,2	28,0	441	50	250	60	160	95	144	70							
100 FLEN 0400	5,1	34,0	482		400						SAE3"3000psi DN80	M16	Ø240	M16	Ø170	22	20
100 FLEN 0630	7,8	38,3	632	65	400	70	195	105	158	90							

<sup>1)</sup> = Weight including standard filter element and maintenance indicator

<sup>2)</sup> = Construction dimension for filter element change

More technical data see data sheet No. T40.1 F-GB  
 Technical modification reserved!